

DYNAMIC[™]
LEARNING MAPS

**Guide to Retrieving Student Usernames and
Passwords
2017-2018**



Revision: September 12, 2017

Version: 2.0

Retrieving Student Username and Password

1. Click Manage Tests.

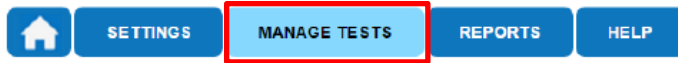



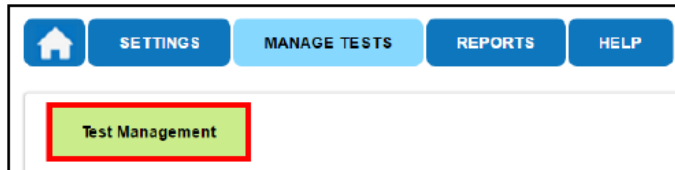

2. Click Test Management.

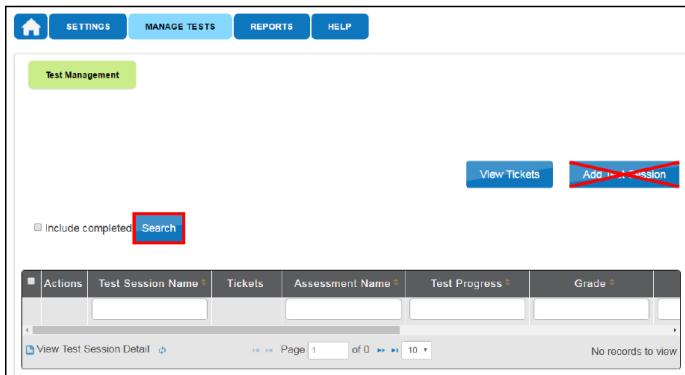

3. Click Search.



4. Click the PDF Icon under Tickets next to the name of the desired test.

	Test Session Name	Tickets	Test Information	Roster	Test Progress	Scho
<input type="checkbox"/>	DLM-LangasMari-12345-SP ELA PP			Smith Mari ELA Grade 5	4 out of 5	001 De
<input type="checkbox"/>	DLM-SmithJohn-67890- SP SCI T			Smith Mari Science	3 out of 5	001 De

5. Click Open with; choose Adobe Acrobat.

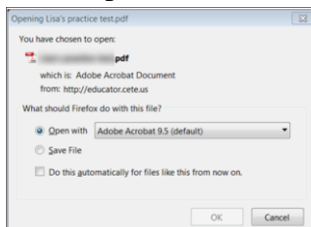

6. Click Ok.

7. View the student username and password.

Playground Demo 1 - Smith
First Name: Jesse Last Name: Callahan UserName: 55557 Password: y4t95 Test Collection: Check Graph Labels Test Form: Check Graph Labels Test Section: Section 1 Ticket Number: N/A